



For brake add [-B] to end of part number. Swivel radius for 50mm is 2-3/8", 60mm is 2-1/2", 75mm is 3-3/16", 100mm is 4-1/2", 125mm is 5-1/8".



For brake add [-B] to end of part number. Swivel radius for 50mm is 2-3/8", 60mm is 2-1/2", 75mm is 3-3/16", 100mm is 4-1/2", 125mm is 5-1/8".



For brake add [-B] to end of part number. Swivel radius for 50mm is 2-3/8", 60mm is 2-1/2", 75mm is 3-3/16", 100mm is 4-1/2", 125mm is 5-1/8".

## Grip Ring Stem Models

Wheel Diameter	Tread Material	Dynamic Load	Mounting Height	Swivel Radius	Part Number	Fastening Selection
50mm	Nylon	75lb	2-1/4"	1-13/16"	PUT50__BK	223, 211, 273
	Urethane	75lb	2-1/4"	1-13/16"	PUT50__BK-U	223, 211, 273
60mm	Nylon	100lb	2-5/8"	2-1/16"	PUT60__BK	223, 211, 273
	Urethane	100lb	2-5/8"	2-1/16"	PUT60__BK-U	223, 211, 273
75mm	Nylon	165	3-3/16"	2-1/2"	PUT75__BK	223, 211, 291, 242
	Urethane	165	3-3/16"	2-1/2"	PUT75__BK-U	223, 211, 291, 242
100mm	Nylon	175	4-5/16"	3-5/8"	PUT100__BK	291, 211
	Urethane	175	4-5/16"	3-5/8"	PUT100__BK-U	291, 211
125mm	Nylon	180	5-5/16"	4-1/2"	PUT125__BK	291, 211
	Urethane	180	5-5/16"	4-1/2"	PUT125__BK-U	291, 211

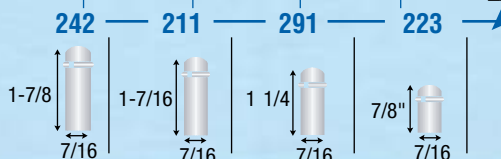

To order include fastener code. Example: (PUT75**223**BK).

## Grip Neck Stem Models

Wheel Diameter	Tread Material	Dynamic Load	Mounting Height	Swivel Radius	Part Number	Fastening Selection
50mm	Nylon	75lb	2-1/4"	1-13/16"	PUT50302BK	302
	Urethane	75lb	2-1/4"	1-13/16"	PUT50302BK-U	302
60mm	Nylon	100lb	2-5/8"	2-1/16"	PUT60302BK	302
	Urethane	100lb	2-5/8"	2-1/16"	PUT60302BK-U	302
75mm	Nylon	165	3-3/16"	2-1/2"	PUT75302BK	302
	Urethane	165	3-3/16"	2-1/2"	PUT75302BK-U	302



## Swivel Top Plate Models

Wheel Diameter	Tread Material	Dynamic Load	Mounting Height	Swivel Radius	Part Number	Fastening Selection
50mm	Nylon	75lb	2-3/8"	1-13/16"	PUT50101BK	101
	Urethane	75lb	2-3/8"	1-13/16"	PUT50101BK-U	101
60mm	Nylon	100lb	2-3/4"	2-1/16"	PUT60101BK	101
	Urethane	100lb	2-3/4"	2-1/16"	PUT60101BK-U	101
75mm	Nylon	165	3-1/2"	2-1/2"	PUT75__BK	101, 120, 116
	Urethane	165	3-1/2"	2-1/2"	PUT75__BK-U	101, 120, 116
100mm	Nylon	175	4-5/8"	3-5/8"	PUT100__BK	120, 116
	Urethane	175	4-5/8"	3-5/8"	PUT100__BK-U	120, 116
125mm	Nylon	180	5-5/8"	4-1/2"	PUT125__BK	120, 116
	Urethane	180	5-5/8"	4-1/2"	PUT125__BK-U	120, 116

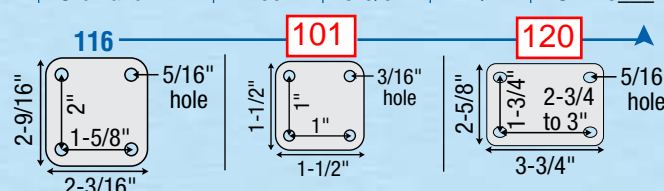

To order include fastener code. Example: (PUT75**101**BK).